



Assembly Instructions for
Gear Drive Pan Kit for 37mm Spur Gear Motor
SKU: 3208-0002-0001



Kit Contents

Tools Required

- 2.5mm Hex Key
- 3mm Hex Key

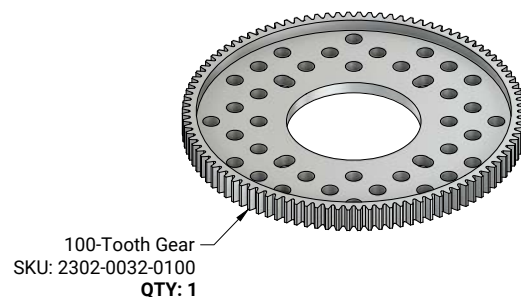
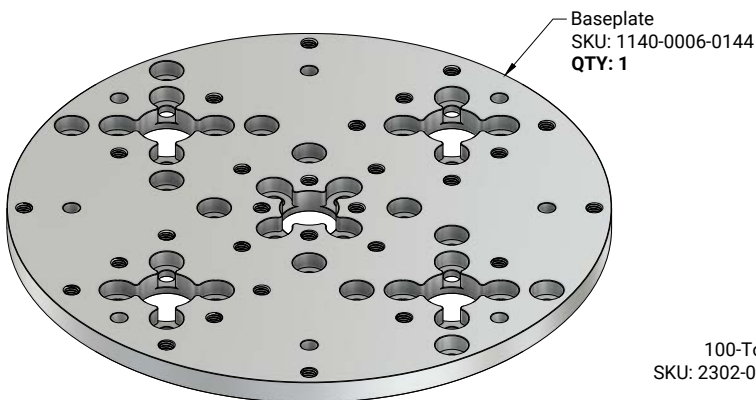
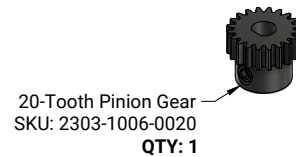
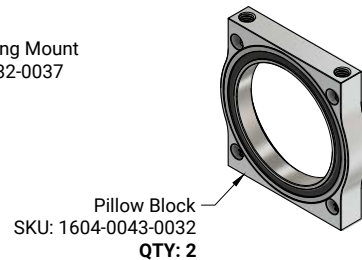
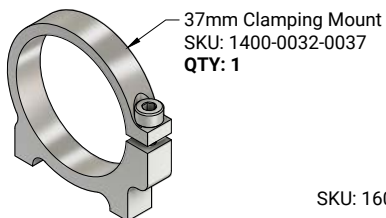
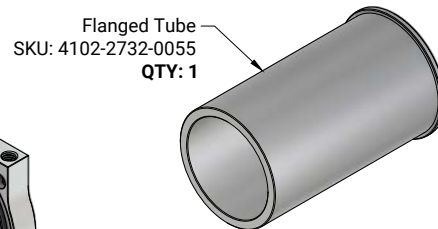
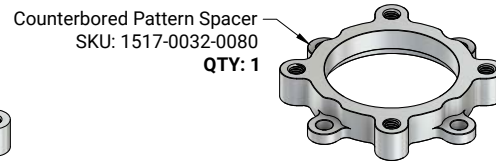
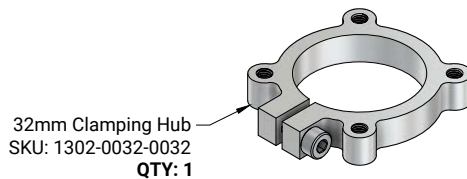
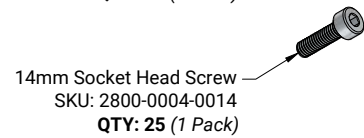
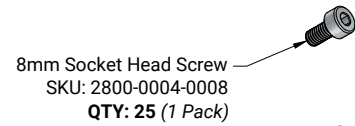
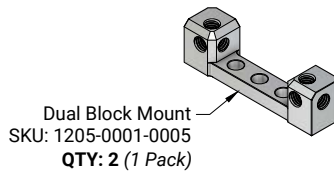
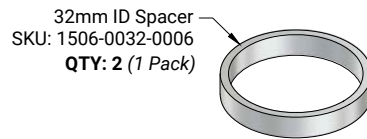
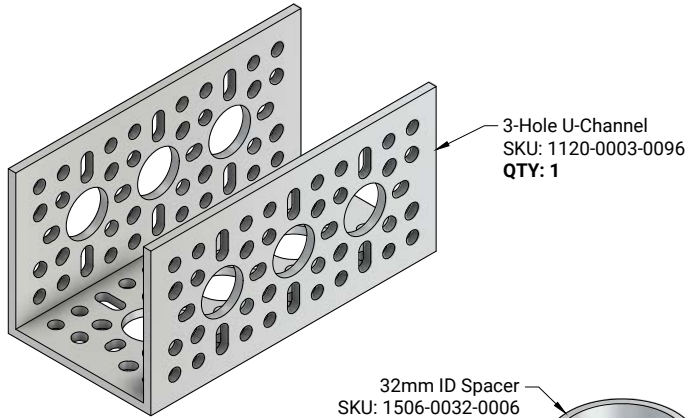

STEP 1:

Attach **one** 37mm Clamping Mount to **one** 3-Hole U-Channel using **two** 8mm Socket Head Screws as shown.

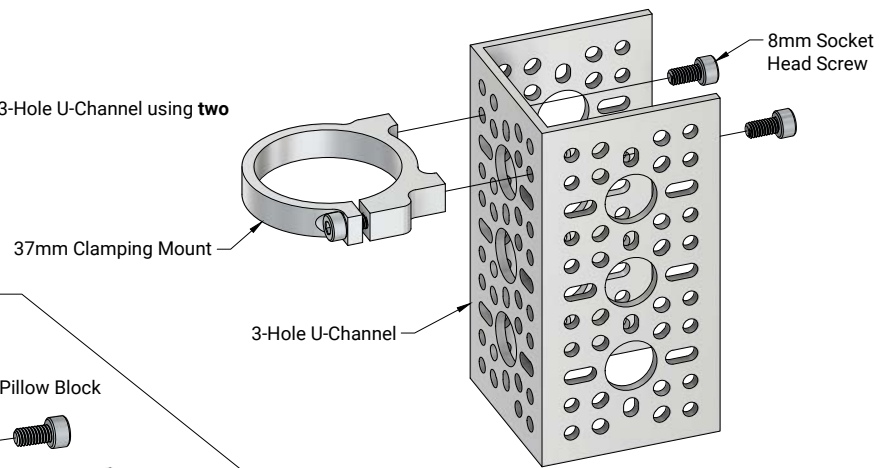

STEP 2:

Fasten **two** Pillow Blocks inside the 3-Hole U-Channel using **eight** 8mm Socket Head Screws as shown. Note the orientation of each Pillow Block.

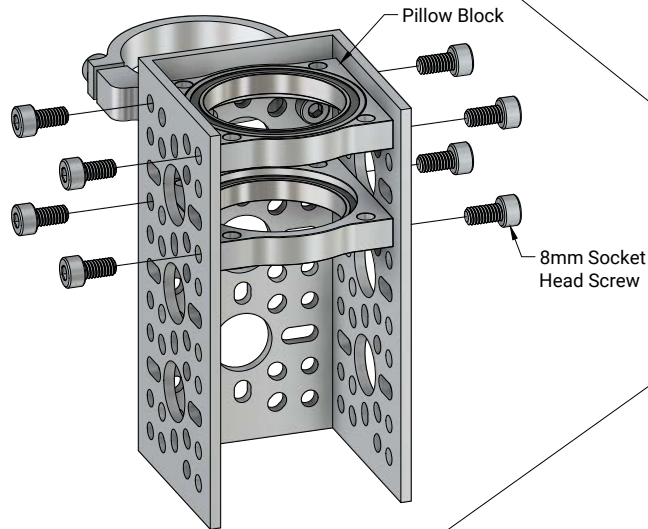

STEP 3:

Slide **one** Flanged Tube through the pillow blocks and **one** 32mm ID Spacer. Fasten in place with **one** 32mm Clamping Hub as shown.

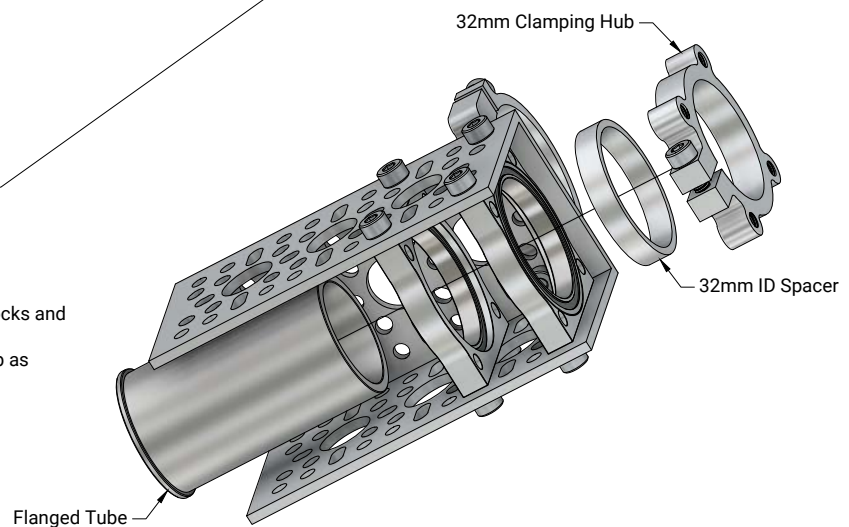

STEP 4:

Use **four** 14mm Socket Head Screws to mount **one** 100-Tooth Gear and **one** Counterbored Pattern Spacer as shown.

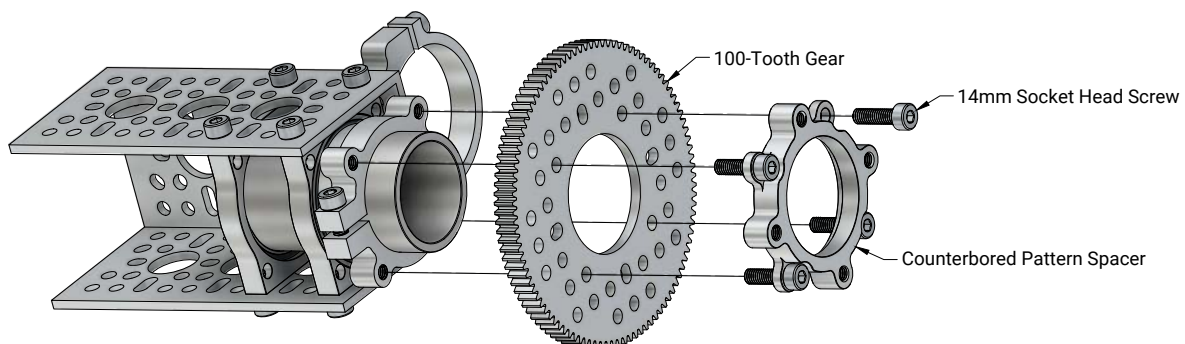

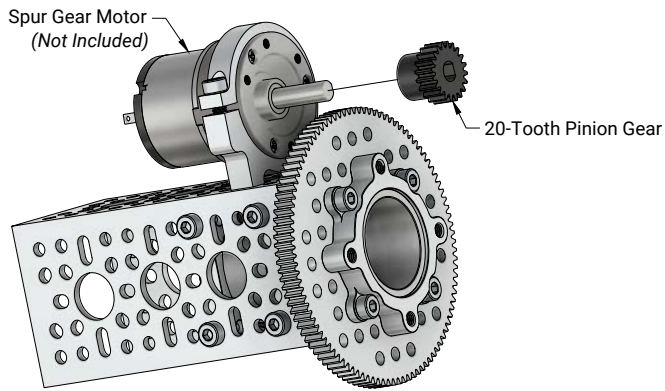

STEP 5:

Fasten **one** Spur Gear Motor (*Not Included*) in place using the 37mm Clamping Mount. Attach **one** 20-Tooth Pinion Gear as shown.

Adjust the Spur Gear Motor (*Not Included*) so that the teeth of the 20-Tooth Pinion and the 100-Tooth Gear are at the same height and fully engaged (**FIGURE 5-A**).

FIGURE 5-A

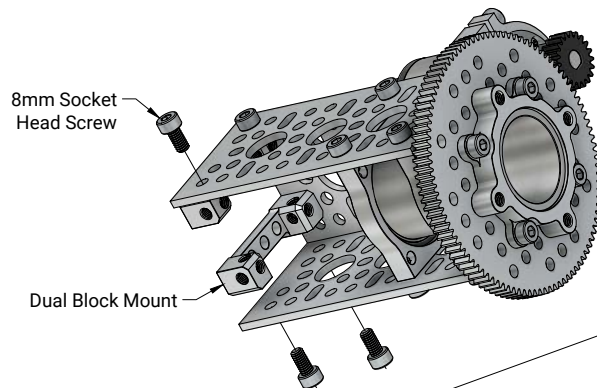
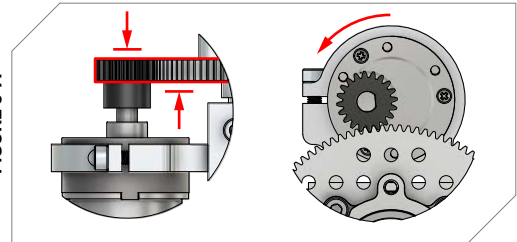

STEP 6:

Attach **two** Dual Block Mounts using **four** 8mm Socket Head Screws as shown. Note the orientations of the Dual Block Mounts.

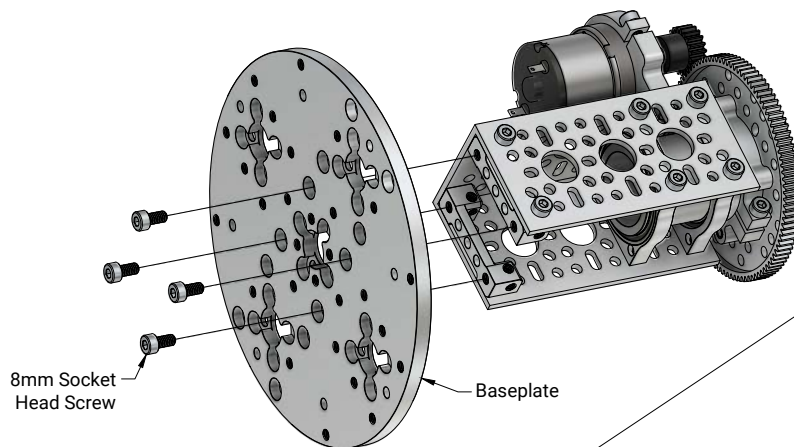

STEP 7:

Attach **one** Baseplate using **four** 8mm Socket Head Screws as shown.

Congratulations!

We bet that putting these parts together has set your imagination spinning.
Prepare your plans for new possibilities of project rotation!

